

Direct application of tiles

System E-ENERGY CARBON FLEECE

- 1 Tiles | Natural stone
- 2 Sealing in damp rooms if necessary
- 3 Tile adhesive approx. 2 mm per layer
- 4 E-ENERGY CARBON FLEECE
- 5 Edge insulation strips EPS | NEO
- 6 Primer
- 7 If necessary moisture barrier (bond to the substrate)

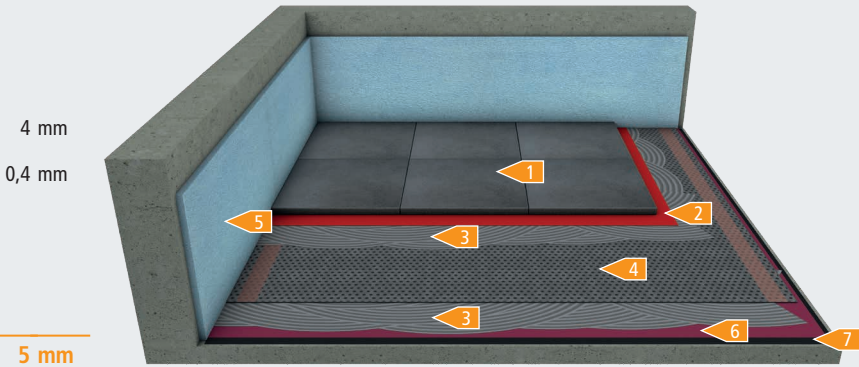

Without additional thermal insulation

	-	No thermal insulation available
	-	No thermal insulation available
	-	No impact sound present

	8 kg / m ² without flooring
	≤ 5.0 kN / m ²
	≤ 4.0 kN * ≥ 20 cm ²

Category	EN 1991	EN 1991/NA	SIA 261
	✓ A	✓ A2 A3	✓ A1
	✓ B	✓ B1 D1	✓ B
	✓ C1 C2 C3 D1	✓ B2 B3 C1 C2 C3 C5 D2 E1	✓ C D

- Prepare level, clean, load-bearing substrate. Dry screeds and wood-based panels must always be laid in two layers and offset
- Wooden beam ceilings must be torsion-resistant and deflection-free
- For adhesive and product recommendations see material approvals
- The technical values are indicative and depend on the manufacturer and the used materials can vary. The manufacturer's instructions and generally accepted rules of technology must always be observed.